



**FORTUNE & COATES**

The People's Estate Agent

<https://www.fortuneandcoates.co.uk>



### 3 Birch Walk, Harlow, CM17 0FQ

Guide price £460,000

Guide Price £460,000-£480,000. Situated in this highly sought after Gilden Park development is this immaculately presented four bedroom end terrace house in Birch Walk. To the ground floor, you are welcomed via the entrance hall which presents the modern fitted kitchen with a range of wall and base units as well as featuring an impressive breakfast bar, large lounge and cloakroom. To the first floor, the property comprises three well proportioned bedrooms, and a beautiful family bathroom. To the second floor, you benefit from the stunning master bedroom boasting the en-suite shower room. Externally, you have a spacious rear garden mostly laid to lawn, featuring a patio area perfect for entertaining. You also have allocated parking for two cars, gas heating via radiators and UPVC double glazing throughout. This perfect family home in Birch Walk falls within a short walk from local amenities, as well as being in a great catchment area for both primary and secondary schools.

Entrance hall

Kitchen 9'8" x 11'1" (2.95m x 3.4m)

Lounge 14'6" x 16'0" (4.42m x 4.88m)

Cloakroom

Bedroom One 10'11" x 18'9" (3.35m x 5.74m)

En suite 5'4" x 9'8" (1.65m x 2.95m)

Bedroom Two 11'6" x 9'10" (3.53m x 3.02m)

Bedroom Three 9'6" x 10'9" (2.92m x 3.28m)

Bedroom Four 11'5" x 5'10" (3.48m x 1.8m)

Bathroom 6'7" x 6'7" (2.03m x 2.01m)



Floor Plan

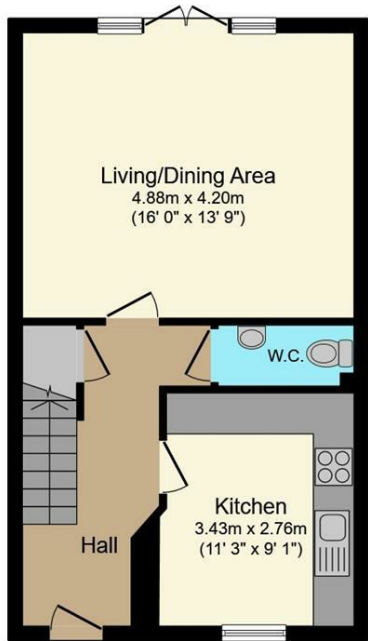

**Ground Floor**  
Floor area 42.6 sq.m. (459 sq.ft.) approx

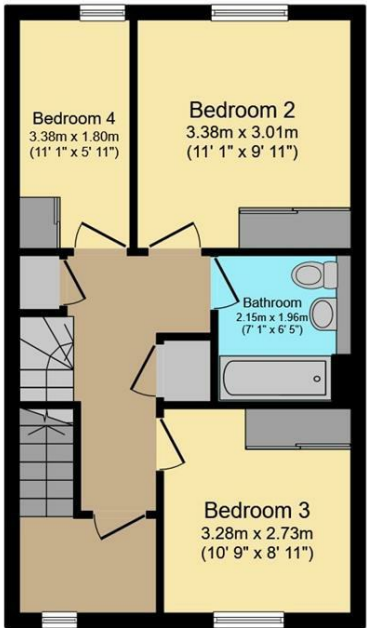

**First Floor**  
Floor area 42.6 sq.m. (459 sq.ft.) approx

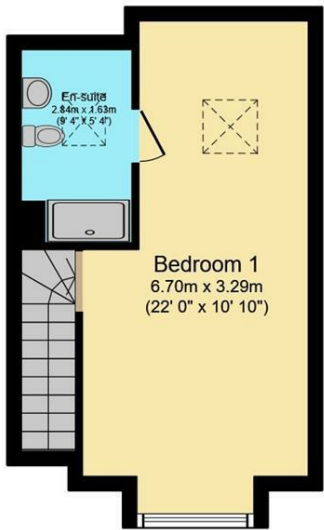

**Second Floor**  
Floor area 28.2 sq.m. (303 sq.ft.) approx

Total floor area 113.4 sq.m. (1,220 sq.ft.) approx  
This Floor Plan is for illustration purposes only and may not be representative of the property. The position and size of doors, windows and other features are approximate. Unauthorized reproduction prohibited. © PropertyBOX

Area Map

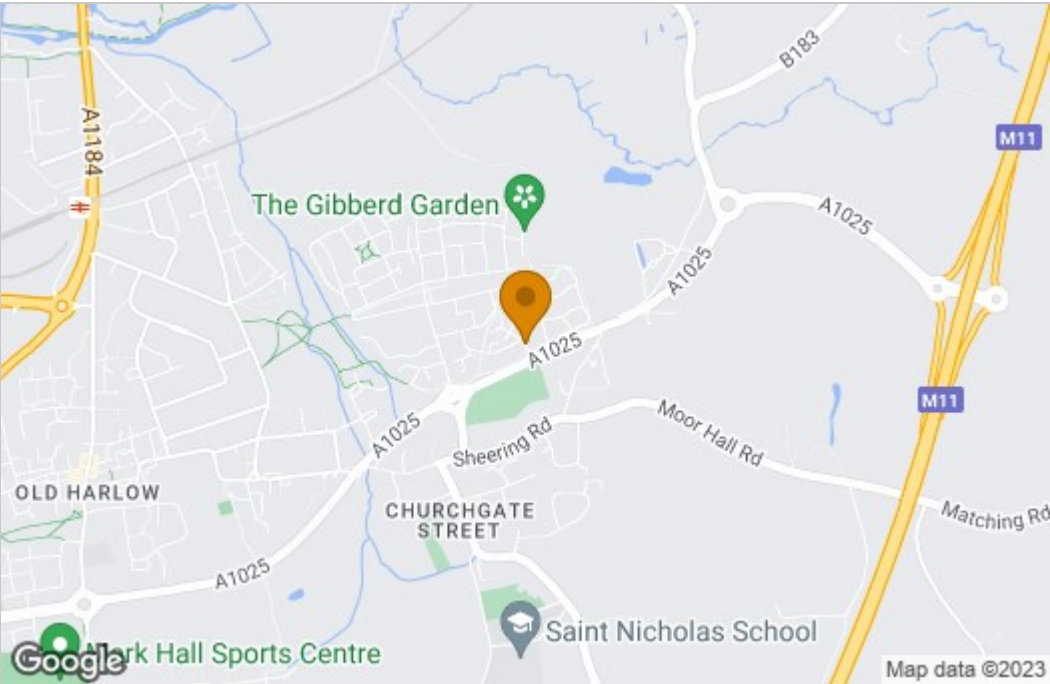

Energy Efficiency Graph

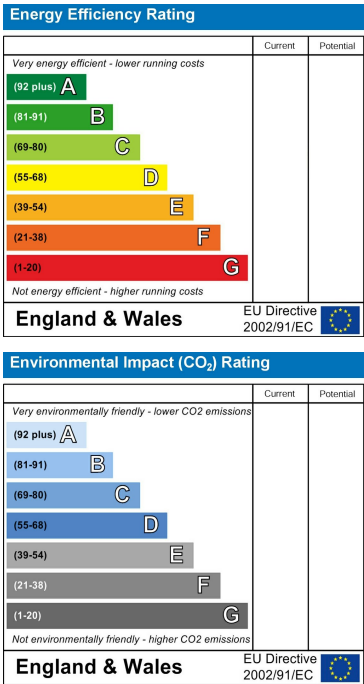

These particulars, whilst believed to be accurate are set out as a general outline only for guidance and do not constitute any part of an offer or contract. Intending purchasers should not rely on them as statements of representation of fact, but must satisfy themselves by inspection or otherwise as to their accuracy. No person in this firms employment has the authority to make or give any representation or warranty in respect of the property.